

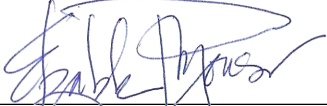





INDEX	
SHEET NO.	SUBJECT
1	COATING REQUIREMENTS FOR STRUCTURAL STEEL INDEX
2	COATING REQUIREMENTS FOR WEATHERING STEEL
3	COATING REQUIREMENTS FOR EXISTING STRUCTURAL STEEL ENCASED IN CONCRETE

INDIANA DEPARTMENT OF TRANSPORTATION									
COATING REQUIREMENTS FOR STRUCTURAL STEEL INDEX SEPTEMBER 2024									
STANDARD DRAWING NO. E 619-PRWS-01									
	<table><tr><td></td><td>04/12/2024</td></tr><tr><td>DESIGN STANDARDS ENGINEER</td><td>DATE</td></tr><tr><td></td><td>04/22/2024</td></tr><tr><td>CHIEF ENGINEER</td><td>DATE</td></tr></table>		04/12/2024	DESIGN STANDARDS ENGINEER	DATE		04/22/2024	CHIEF ENGINEER	DATE
	04/12/2024								
DESIGN STANDARDS ENGINEER	DATE								
	04/22/2024								
CHIEF ENGINEER	DATE								

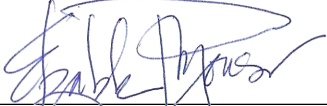
NOTE:

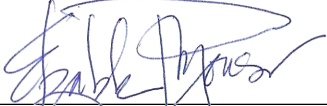
1. Caulk shall be placed on the coated surface at the coated/uncoated interface and is intended to function as a drip bead.

LEGEND:

 = Area to be coated

 = Caulk Bead

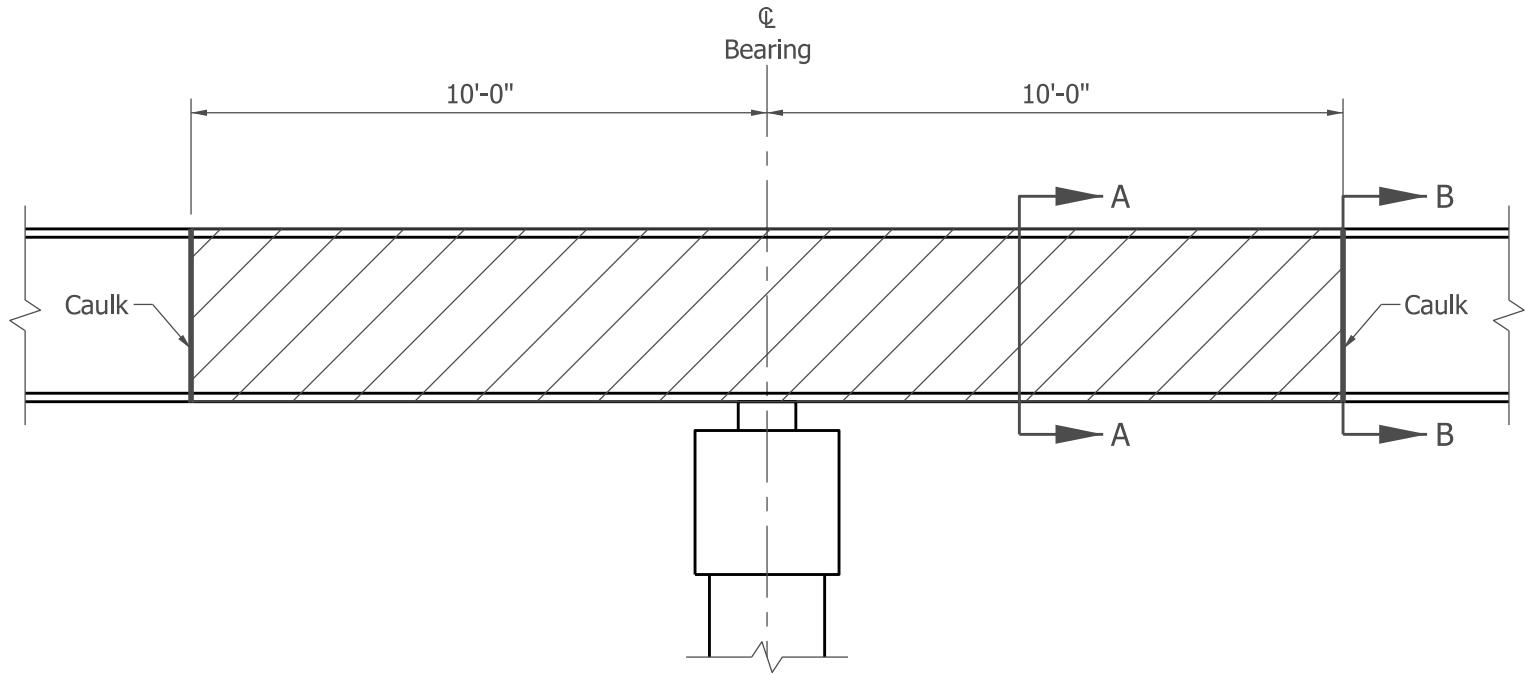

BEAM OR GIRDER AT INTERIOR SUPPORT

ELEVATION VIEW
(Bridge Deck not shown for clarity)

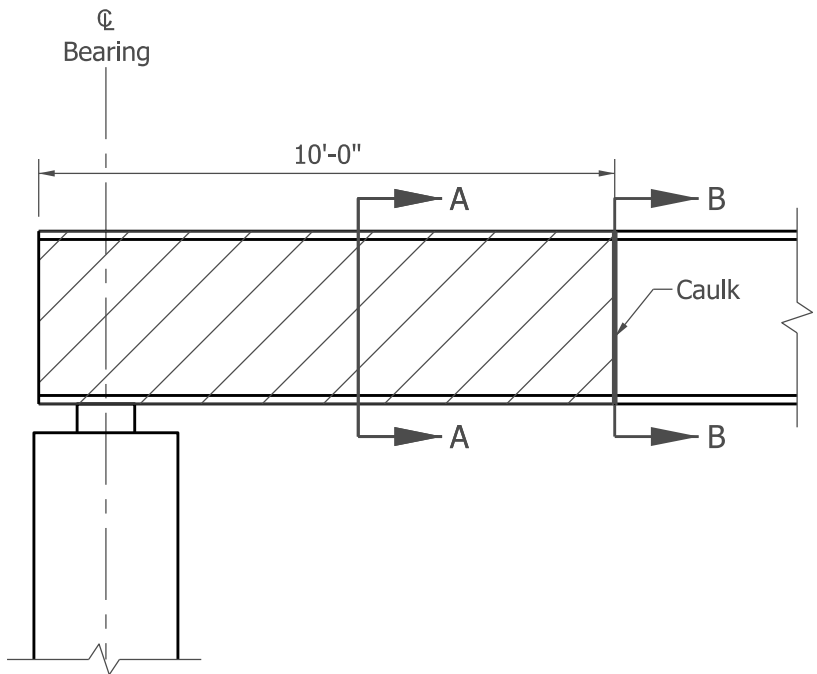

BEAM OR GIRDER AT END-BENT SUPPORT

ELEVATION VIEW
(Bridge Deck, Mudwall, and Concrete Encasement not shown for clarity)

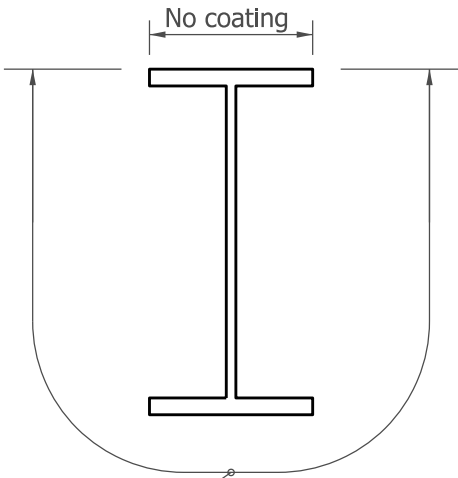

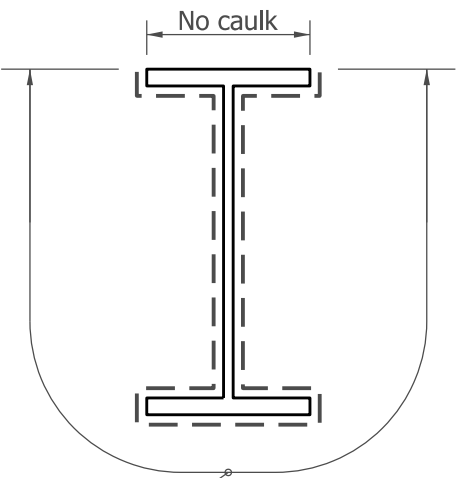

SECTION A-A

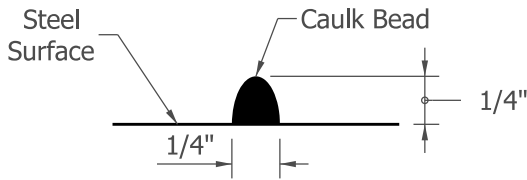

SECTION B-B

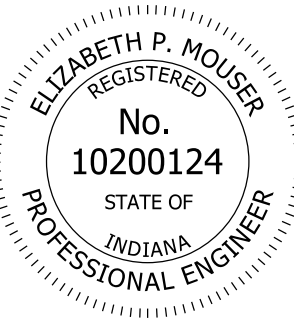
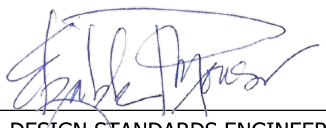

CAULK BEAD DETAIL

INDIANA DEPARTMENT OF TRANSPORTATION	
COATING REQUIREMENTS FOR WEATHERING STEEL	
SEPTEMBER 2024	
STANDARD DRAWING NO. E 619-PRWS-02	
	 DESIGN STANDARDS ENGINEER 04/12/2024 DATE
	 CHIEF ENGINEER 04/22/2024 DATE

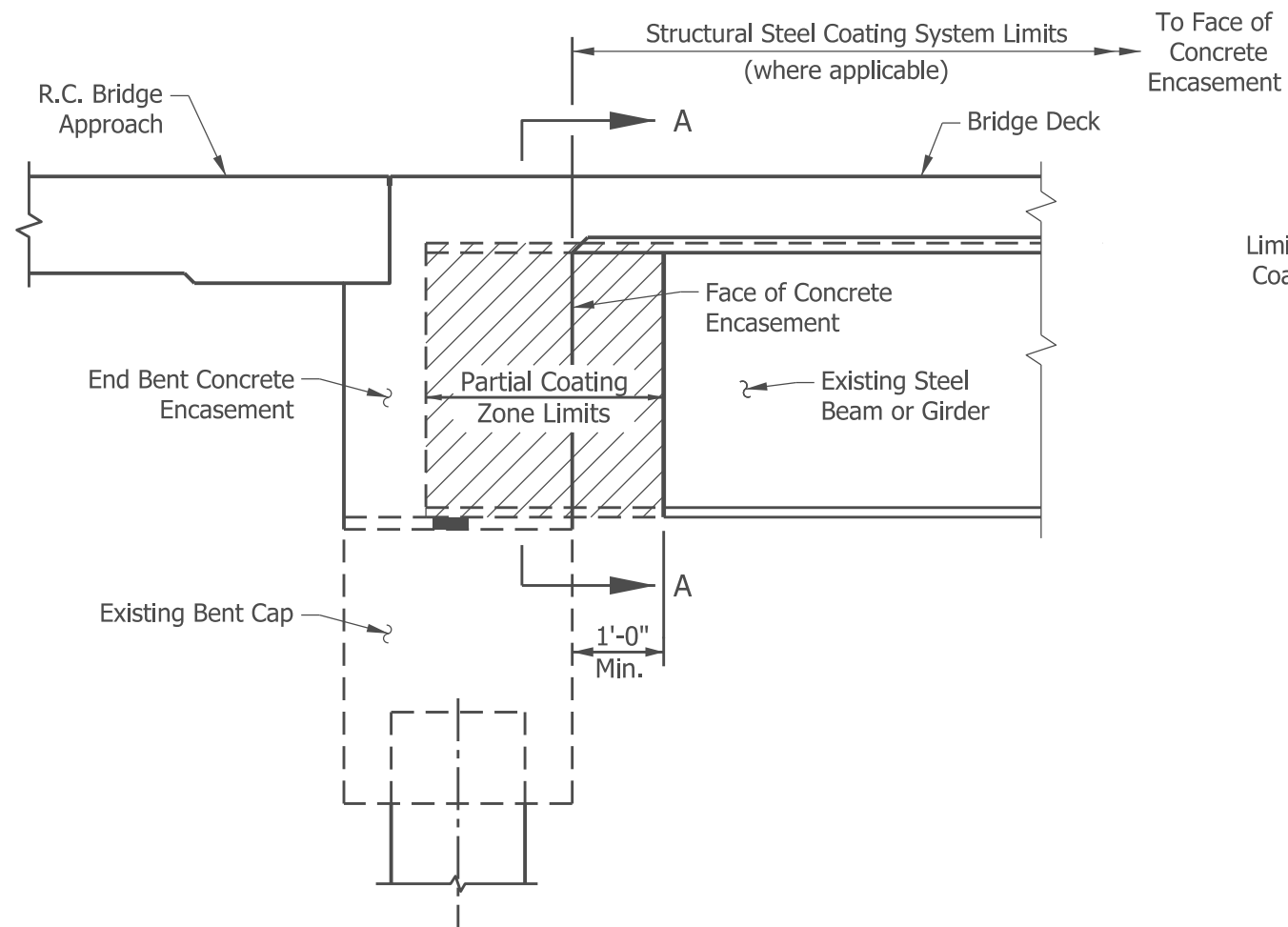

EXISTING STRUCTURAL STEEL MEMBERS
ENCASED IN CONCRETE

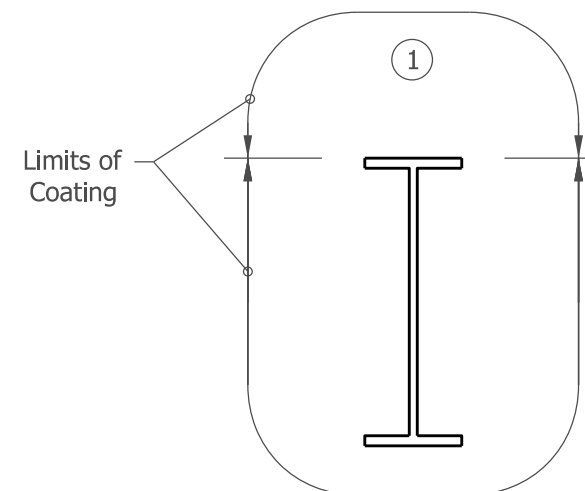

SECTION A-A

NOTE:

- ① Where shear connectors have been specified, the top of the top flange shall not be coated.

LEGEND:



 = Area to be coated

INDIANA DEPARTMENT OF TRANSPORTATION

COATING REQUIREMENTS FOR
EXISTING STRUCTURAL STEEL
ENCASED IN CONCRETE
SEPTEMBER 2024

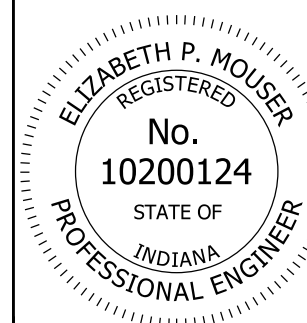
STANDARD DRAWING NO. E 619-PRWS-03

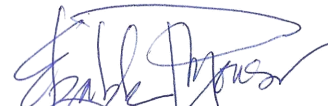

	04/16/2024
DESIGN STANDARDS ENGINEER	DATE
	04/22/2024
CHIEF ENGINEER	DATE